

NOTICE OF SEALED BIDS FOR TIMBER STUMPAGE
BURNETT COUNTY FOREST

- I. BIDDING: Sealed bids will be accepted by the Burnett County Natural Resources Committee for the purchase of the marked or designated stumpage on the attached tracts. Bids will be opened on Thursday, October 11, 2018 after 9:30 a.m. in Room 165 of the Burnett County Government Center, Siren, WI. MAILED BIDS MUST BE RECEIVED BY 4:30 p.m., October 10, 2018 and HAND DELIVERED BIDS MUST BE RECEIVED BY 9:30 a.m., October 11, 2018. The next Timber Sale is scheduled for April 2019.

Burnett County reserves the right to reject any or all bids. New bids will not be accepted after the beginning of the bid opening. Bids can be sent or delivered to Burnett County Forest & Parks Dept., 8150 State Road 70, Siren, WI 54872.

All bids must be made separately for each tract by indicating a per unit price by volume type for each species and product listed. When submitting bids, be sure to select desired utilization. The entire sale must be bid in ton. The only exception to this will be when bidding on MBF that are scaled by the forester on the landing. **Acceptable bids must meet or exceed the total advertised sale value. Bids below total sale advertised values, or incomplete bids, will be rejected. No bids can be pulled at any time once the reading of the 1st tract has started.** Tracts designated as lump sum sales require only one bid for the total volume of all species listed and the total bid value must exceed the total advertised value. Volumes on lump sum sales are estimated volumes and actual harvest volumes may differ but will not change the bid value. Utilization of designated trees on lump sum sales must meet minimum utilization standards as specified in the contract. Final settlement on scaled sales will be based on actual volumes designated for harvest by the contract.

The Burnett County Natural Resources Committee will award contracts to the acceptable high bidder pending verification of each winning bid. On product scaled sales, the total combined bid for each tract will be recalculated by Burnett County using each bidder's per unit price to verify that the total combined bid values are correct. County calculated values will be used to award bids and issue contracts. For lump sum sales, the total lump sum bid value for each tract will be used to award bids. The Committee reserves the right to reject bids from contractors with delinquent stumpage payment 60 days past due.

Bidders may choose, by written notice on the bid, their intention to mix or blend species of pulpwood removed from the sale. This notice will not affect the bidding process, but will be used to prepare the initial contract and establish a stumpage price for blended species. The contract will be written with the stumpage price for all volumes pre-calculated using the blend species formula. The value of blended species timber removed from a sale will be calculated on a PER TON basis regardless of how it is scaled or weighed. Also, each pulpwood load containing one of the species to be mixed will be billed according to the average price per ton regardless of whether it is delivered as a mixed load or single species load. Softwood saw-timber can be included in the blended species formula only if delivered to a pole length mill that provides weight scale. If a contractor enters into a contract for standard pure loads as bid but later hauls mixed loads from the sale, the County will use the highest bid value of any species included in the load to determine the stumpage charge for the entire load. A sample of the blended species formula is available from the County Forest Office.

The Truck Ticket System or Woods Scale System will be used to account for wood charged to scaled sale contracts. Wood removed without being reported by using a truck ticket at the time of hauling or without being scaled by the County will be assessed a minimum of double stumpage. Optional species, if bid on, will automatically become a required species to cut and will be included in the total sale value to determine the high bidder.

Bids for whole tree harvesting may be accepted on specified tracts. Contractors submitting a bid for whole tree harvesting must use the whole tree volumes as stated on the bid sheet by species. The sale bid value must exceed the minimum appraised value and will be used to determine the highest bidder. Burnett County will determine all volumes by using the same weight conversion rates as standard roundwood harvest, for the total volume of all chips. All roundwood and chips will be paid for at the ton bid price. Also, all chip operations will cut and utilize all trees 2" or larger. If the contract is not whole tree harvested as bid, we will add the percent difference between the roundwood and the whole tree volumes to determine the stumpage assessment for each species.

Each bid must be accompanied by a check, cashiers check, or cash, (checks payable to Burnett County Treasurer), in the amount of \$200.00. Successful bidders who fail to sign their contract will forfeit their \$200.00 bid bond and will not be allowed to bid on Burnett County stumpage for two years. The bid deposit will be returned to unsuccessful bidders. Burnett County will hold the \$200.00 bid deposit on winning bids until a 10% performance bond is received by the County, this can either be a check, cashiers check, cash or Irrevocable Letter of Credit from a Wisconsin Bank, (payable to Burnett County Treasurer). The 10% performance bond will be held separately from stumpage payments and may be retained if damages or noncompliance of the sale contract occurs. Upon successful completion of the contract, the performance monies will be returned after timber sale closing. The

successful bidder must sign a timber sale contract with the County within 30 calendar days of the letting of the bids. Sample copies of the contract and the letter of credit are available by request. **Letters of credit to replace cash bid deposits must be received within ten working days of receiving the contract.**

Contract expiration for tracts sold at this offering will be November 1, 2020, unless stated otherwise on the tract description. Contract extensions on scaled sales may be issued in six-month increments. Lump Sum Sales will not be extended. If extensions are granted, stumpage prices will be increased by a minimum of 10% for each extension and prepayment of stumpage may be requested. New bidders and other bidders unfamiliar with Burnett County Forest Timber Sale Policies should contact the Forest Administrator prior to bidding. The Administrator reserves the right to require an onsite meeting with the successful bidder before any operations can begin. The successful bidder who signs the contract is considered to be the sole holder of this contract with Burnett County and may not assign or transfer this contract or obligation to another without written authorization from Burnett County.

- II. **STUMPAGE PAYMENT:** All lump sum sales and other sales less than \$2,000 require 100% prepayment of the total estimated sale value before sale operations begin. On all sales between \$2,000 and \$20,000, a 50% prepayment of the total estimated sale value must be made before operations begin. At or near the time when half the estimated value is cut, the remaining 50% payment will be made. On sales of more than \$20,000, stumpage prepayment can be made in three installments. At no time may wood leave the site before payment is made to the County for these volumes.
- III. **VOLUME STANDARDS:** The County reserves the right to either accept mill scale or scale wood on the site. Pulpwood merchantability standards are: all hardwoods with at least one 100" stick to a 4" top; all pine with at least one 100" stick to a 3" top, unless specified differently. Sawlog merchantability standards are: all pine with at least one 100" log to a 9" top; all hardwoods with at least one 100" log to a 10" top. The following conversion rates will be used to convert cordwood to tons: 4500 lbs/cd for aspen; 4250 lbs/cd for balsam fir; 4800 lbs/cd for white birch; 5200 lbs/cd for mixed hardwoods; 4250 lbs/cd for jack pine; 4500 lbs/cd for red pine; and 5500 lbs/cd for scrub oak. **(See attached sheet with Burnett County weight conversion rates.)** The WDNR Timber Sale Handbook will provide conversion rates for other species. Contractors intending to haul loads of mixed species using the truck ticket system must have prior authorization from Burnett County Forest for each sale before hauling begins. If hauled without authorization, the price and weight conversion rate of the species with the highest contract price included in the truckload will be used to determine the stumpage value of the entire load. All sawlogs will be scaled using Scribner Decimal C Log rule. Weight scale for pine sawlogs may be accepted only through written agreement with the Forest Administrator. Sap peeled wood will be converted by adding 12½% to wood scale. Machine peeled wood will be converted by adding 25%. All site scaled wood will be "woods run" and will be final. Mill scale is acceptable using the provisions as described in the contract.
- IV. **INSURANCE REQUIREMENTS:** Successful bidders must agree to perform all operations under their contract in compliance with Wisconsin's Compensation Act, Chapter 102 Wisconsin Statutes. The successful bidder must provide Burnett County with a Certificate of Insurance indicating Workers Compensation coverage is in force for all timber producers on the site as well as general liability insurance coverage, (\$500,000 minimum). Burnett County will be listed as a holder of the certificate and an original copy of the certificate must be on file before work on the sale begins. It is understood that there is no employer-employee relationship between the County and the purchaser.
- V. **OTHER REQUIREMENTS:** All successful bidders must have a Seller's Permit number filed in the Burnett County Forest & Parks Office. Without a current permit, contractors will be obligated to pay Wisconsin Sales Tax on the value of wood purchased.

All successful bidders must supply Burnett County with a current Certificate of Wisconsin SFI Training Standard for at least one "in woods" person actively responsible for each logging site. This certificate is required upon signing of the contract. For a list of the Wisconsin SFI Training Standards, contact the Burnett County Forest & Parks Office.

All successful bidders will comply with the guidelines for Wisconsin's Forestry Best Management Practice for Water Quality.

The contractor must contact the Burnett County Forest & Parks Office a minimum of two working days prior to starting a sale contract. Failure to do so will be considered a contract violation and a portion of the performance bond will be retained. All new road construction and landings must have approval by the Forest Administrator's Office prior to construction. Trees tipped or pushed out during road construction will be utilized. Logging roads used by the contractor will be cleared of debris and restored to presale conditions.

Logging debris, (tops, slash, branches, cut-offs, ends, etc.), at landings must be leveled and scattered so that the height of this debris is less than 2 feet high. All logging activity, (slash, skidding, and landings), is prohibited on any state or township road right-of-way. Trash such as cans, filters, tires, or other non-biodegradable materials left by the contractor will be considered a littering violation and will be charged under the Burnett County Forest Ordinance.

Contractors will be responsible for all clean up of any petroleum or chemical spills from the contractor's equipment. Stump heights will not be higher than the diameter of the stump cut.

Burnett County does not guarantee access to any advertised tracts across any non-county owned lands. It is the responsibility of the bidder to make arrangements for access across non-county owned lands.

Some tracts will require aspen maintenance or site maintenance. When designated, all live non-merchantable trees, (aspen and other hardwood species), 2" or larger at breast height will be severed by the contractor as part of the contract concurrent with harvest of merchantable wood.

Wood left at a landing over 30 days from the date of the Burnett County close-out notification letter will become the property of Burnett County Forest, unless other arrangements have been made with Burnett County Forest & Parks Department.

All successful bidders will agree to comply with Burnett County Forest's fire protection requirements. The requirements are listed in the contract. In brief, the contractor will install extinguishers on all off-road logging equipment as well as equip all non-turbo charged engines with approved spark arrestors. Burnett County Forest reserves the right to suspend all harvest operations when the risk of fire is high.

The County Forest reserves the right to stop operations if unreasonable, excessive, or avoidable environmental damage has, is, or is about to occur. The contractor may be held responsible to repair any or all environmental damage that, in the County's opinion, was avoidable. Excessive soil rutting is considered avoidable environmental damage.

VI. TRUCK HAULING INFORMATION: Several townships in Burnett County have additional policies to protect their investments in, and limit damage to, their local town roads. Burnett County believes their intent is not to restrict logging on County Forest or private lands, but a response to minimize the expense for road repairs caused by repetitive or inappropriate use by heavy trucks. Most town officials have been very cooperative in resolving town road hauling issues and want to continue to provide good roads for all public uses. Each year, Burnett County distributes to 11 townships, 10% of the gross timber sale receipts from the County Forest that could be used to help maintain town roads.

Several town officials provided summaries of their town road hauling restrictions. It has been suggested by both timber sale producers and the town officials that this information be included in the Burnett County Forest Timber Sale Prospectus. Timber producers can refer to this town road information as they prepare bids for County Forest stumpage. Here is the information provided by the towns:

<u>Town</u>	<u>Contact</u>	<u>Summary</u>
Anderson	Jeremy Gronski	(715-488-2928) Some town roads are posted year round. Please contact town chairman prior to hauling.
Blaine	Vern Drake	(715-410-7861) All asphalt township roads will be posted at 4 ½ ton/axle March 1 st to May 15 th , earlier or later depending on frost and weather conditions. There is a year round 45 ton restriction over the bridge at Chase Brook. Contact the town as a hauling agreement is required.
Daniels	Mike Huber	(715-349-7702) Some seasonal road restrictions do occur. Year around 6 ton single axle/10 ton tandem axle restrictions on Dunham Lake Rd, Old 35 between Daniels 70 to Elbow Lake Road, Range Line Rd. Contact chairman for possible exemption permit.
Jackson	Dianne Connor	(715-866-4645) Road are posted March 15 th to May 15 th , earlier or later depending on frost and weather conditions. Notify town prior to hauling.
Lincoln	Steve Washkuhn	(h-715-866-4201; c-715-566-1742) Roads are limited to 4 ½ ton per axle during spring thaw (time varies dependent on weather conditions). Klarquist Rd, from Cty Hwy D to Lincoln Rd, has a 20,000 lb limit year around. The bridge on Icehouse Bridge Rd is limited to 35 ton year around.
Meenon	Tom O'Brien	(715-791-0203) Contact chairman prior to hauling.
Oakland	Wayne Larrabee	(715-866-4444) Contact chairman prior to hauling.

Roosevelt	Greg Odden	(715-468-2718) Some seasonal road restrictions do occur. The Roosevelt Town Board reserves the right to post roads at its discretion at any time. Notify town prior to hauling so town can schedule road maintenance. Please contact prior to hauling on roads when they are most vulnerable to damage.
Rusk	Dave Olson	(715-468-7487) All town roads have an 8 ton weight limit from March 1 st to May 1 st . Contact town chairman prior to any spring logging in this township.
Sand Lake	Ed Weber	(715-866-4370) Spring posting of all roads with weight limits of 4 ½ ton/axle. Newly surfaced roads are posted for one year.
Siren	Philip Stiemann	(715) 653-4140 Roads are posted March 15 th to May 15 th , earlier or later depending on frost and weather conditions. Contact the town as a hauling agreement is required.
Swiss	Terrance Nelson George Costello	(715) 656-3675 (715) 656-3332 Roads are posted March 15 th to May 15 th , earlier or later depending on frost and weather conditions. Hauling is NOT allowed on: Staples Lake Rd, Airfield Rd, Tower Rd, W. Deer Lake Rd, St. Croix Tr., and Broeffle Rd. Contact the town as a hauling agreement is required.
Union	Marv Merle	(715-866-8576) Roads are posted March 15 th to May 15 th with a 4 ton/axle restriction, earlier or later depending on frost and weather conditions. All year restriction on N. Bailey Rd. Year-round trucking allowed on S. Bailey Rd. Contact the town as a hauling agreement is required.
Webb Lake	Steve Austin	(612-387-5196) Notify town prior to hauling. Roads have seasonal weight limits following the County Highway Dept. timelines from the middle of March to the middle of May.
West Marshland	Jeremy Burton	(715-557-0033) Roads are posted with a 6 ton limit March 15 to May 15, earlier or later depending on frost and weather conditions. Notify town prior to hauling for restrictions.
County Highways	Michael Hoefs	(715-349-2285) Some seasonal weight limits on county highways. Driveway permits are required for new entrances.
County Forest	Jason (Jake) Nichols	(715-349-2157) Damage to county forest roads will be repaired under terms of the Timber Sale Contract. Harvesting may be suspended if damage is excessive and avoidable.

*****Burnett County strongly recommends that the contractor contacts the township and/or county highway officials regarding roads PRIOR to bidding and/or starting sales.*****

These considerations can help minimize damage to roads:

1. Respect and comply with all posted seasonal weight limits. Timber producers should work closely with their hauling contractor to protect roads. Roads are most susceptible to damage in late winter and early spring.
2. Timber harvesting may be possible but hauling may be suspended due to weather conditions.
3. Approaches to town roads should be level or slightly higher than the town road surface to reduce pulling damage on the pavement.
4. Approaches to town roads should be wide enough and angled to reduce the turning friction on paved surfaces.
5. Approaches to town roads should be hardened with gravel or other aggregate to provide a stable road base and to help protect the edge of the road pavement. The County Forest will provide gravel for designated approaches in cooperation with the contractor.
6. Contact town officials prior to bidding or hauling to evaluate and understand any road hauling issues before they occur.
7. County Forest and town officials will attempt to establish pre-approved, designated approaches and town road haul routes when possible.
8. Contact the town officials if you have additional questions.

BCF Weight Conversion Rates

	<u>LBS/CD</u>	<u>TONS/CD</u>
Ash	5100	2.55
Aspen	4500	2.25
Balsam	4250	2.125
Basswood	3850	1.925
Black Ash	4600	2.3
Cedar	4500	2.25
Elm	5300	2.65
Hard Maple	5350	2.675
Hemlock	4600	2.3
Jack Pine	4250	2.125
Mixed Hardwoods	5200	2.6
Oak Mix	5500	2.75
Scrub Oak	5500	2.75
Red Oak	5500	2.75
Red Pine	4500	2.25
Soft Maple	5200	2.6
Spruce	4500	2.25
Tamarack	4500	2.25
White Birch	4800	2.4
White Pine	4650	2.325
White Oak	5400	2.7
Yellow Birch	5400	2.7

BURNETT COUNTY FOREST

Mapped By: Mark Gossman			Project Type Timber Sale		Contract #	
Date Drawn 3/4/2015			Comp 16	Stand 11	Contractor	
Town Blaine (E)			DNR Tract # 9-15		Expiration Date	
Twp 42N	Range 14W	Sections 19,20,30	Acres 69		Scale 1" = 1/4 Mile	



Black Ash Overstory Removal. 9 ac. Cut all Black Ash 8 inches and larger as measured from 4.5 feet from the ground. In addition, cut all merchantable Aspen, Birch, and Maple. Leave all Oak and green painted trees.



Black Ash Spatial Thinning. 48 ac. Leave one dominate merchantable tree at least 6 inches in diameter every 20 feet to yield 20X20 spacing. In addition, cut all merchantable Aspen, Birch, Spruce, and Maple. Leave all Cedar and Yellow Birch.



Black Ash Strip Clearcut. 12 ac. Clearcut all species 25 feet on both sides of the red paint line established as the center of the take area.

	<u>Shortwood Tons</u>	<u>Whole Tree Tons</u>	<u>Approximate Cords</u>	
Ash	1650	2060	715	895
Aspen	55	75	25	35
Mixed Hardwood*	95	120	40	50
Spruce	105	130	45	60

*Mixed hardwood contains 70% Birch and 30% Maple

Minimum Sale Value: \$9,739.50

Special Contract Restriction

- Operation will be stopped, if in the opinion of the forester unnecessary damage occurs.
- Damage to residual trees will result in additional skidding restrictions.
- No slash is to be left in any non-forested wetland.
- All slash shall be lopped to within 2' of the ground.
- Landings shall be located only where indicated by ▲ on the sale map, unless approval is obtained from the forester.
- All softwood must be utilized to a 3" top diameter, hardwoods to 4" top
- Winter Logging Area. Logging permitted only on frozen ground.
- Woods trails and roads must remain open and free of debris during logging operation.
- Road approaches to town and county roads are the responsibility of the contractor.
- Contractor must close entire spur road that may be constructed and road that needs improvement upon completion of the sale with slash and stumps.

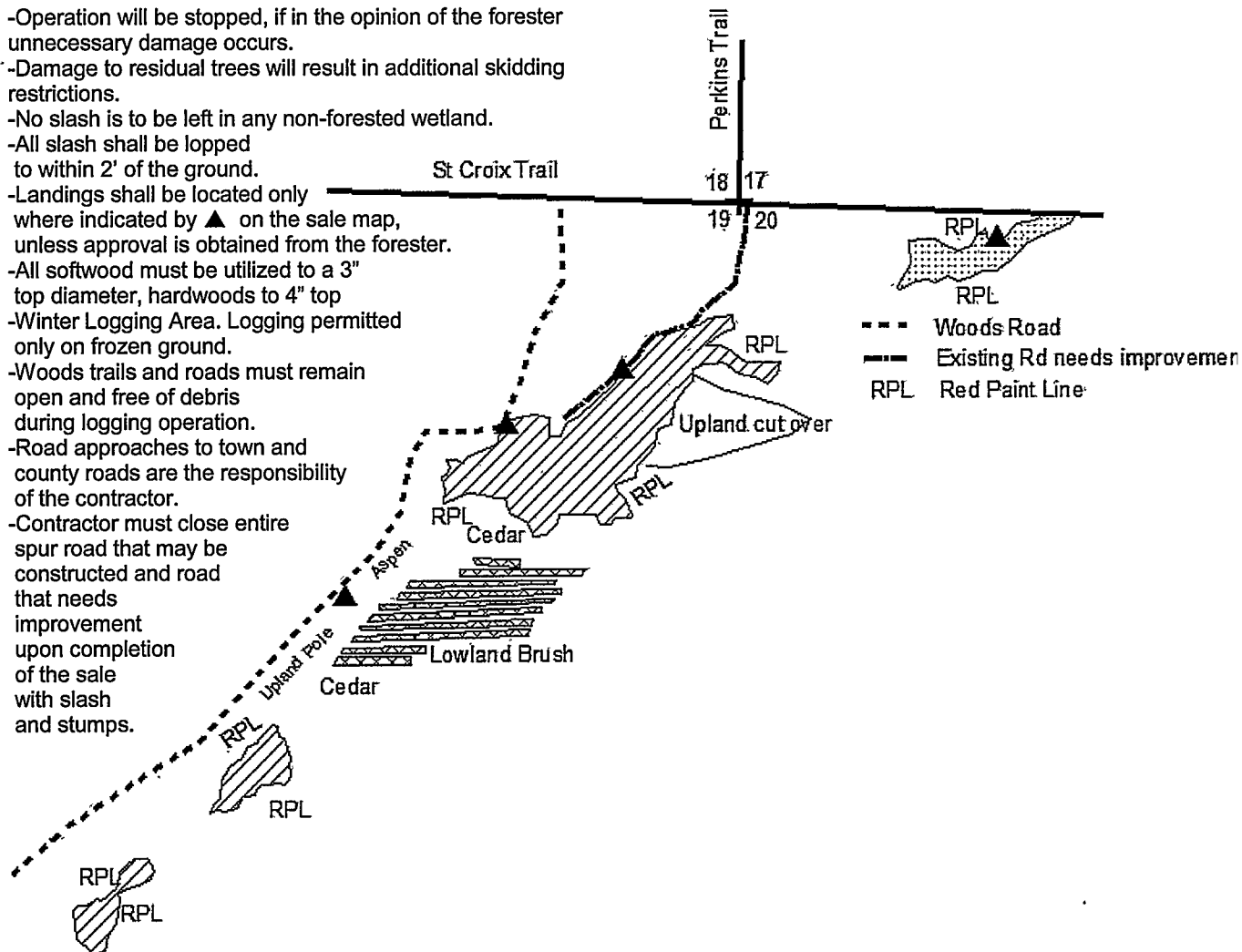

BURNETT COUNTY FOREST TIMBER SALE BID FORM

8150 State Road 70, Siren, WI 54872

Tract #9-15

I hereby submit the following bid for timber stumpage:

Species		Volume	Bid Price	Total Value by Species
Ash	4" ton	1650 ton		
	WT ton	2060 ton		
Aspen	4" ton	55 ton		
	WT ton	75 ton		
Mix Hardwoods	4" ton	95 ton		
	WT ton	120 ton		
Spruce	3" ton	105 ton		
	WT ton	130 ton		

Total Sale Minimum Bid for Tract #9-15

\$9,739.50

TOTAL SALE VALUE =
=

Bid deposit of \$200.00 per tract is required for bid

Successful bidders will be required to submit a 10% Performance Bond, cash or Irrevocable Letter of Credit, within ten working days of receiving the contract.

Do you wish to use the blended species formula for hauling mixed species loads? YES NO

Submitted by: _____
Name

_____ Address

_____ Date

_____ Company Name

_____ City, State, Zip

_____ E-mail address

BURNETT COUNTY FOREST

Mapped By: Mark Gossman			Project Type Timber Sale		Contract #
Date Drawn 4-7-15			Comp 59	Stand 13,18	Contractor
Town Swiss			DNR Tract # 15-15		Expiration Date
Twp 41N	Range 15W	Section 36	Acres 33		Scale 1" = 1/4 Mile



Jack Pine Clearcut. 12 ac. Cut all jack pine, aspen, scrub oak. Cut all hardwood stems 2 inches and larger. Leave all white pine and red pine. Proposed scarification site. No cutting until scarification is completed by the county during a non-frozen period. Harvest must be completed within one year of scarification. Jack pine tops must be lopped and scattered directly on scarified areas. No full tree skidding is allowed. Leave all green painted trees near the SE part of the sale.



Aspen/Red Pine Harvest Area. 21ac. Cut all aspen, jack pine, birch and scrub oak. In addition, cut all red pine marked with orange paint.

	<u>Shortwood Tons</u>	<u>Approx. Cords</u>
Aspen	540	240
Jack Pine	475	225
Red Pine	470	210
Scrub Oak*	70	25

Minimum Sale Value: \$24,765.00

*Includes a small amount of red maple and birch

Special Contract Restriction

- All wood cut or in piles shall be removed within 30 days.
- Operation will be stopped, if in the opinion of the forester unnecessary damage occurs.
- Damage to residual trees will result in additional skidding restrictions.
- No equipment within 15' of wetland edges during non-frozen time of year.
- All slash shall be lopped to within 2' of the ground.
- Landings shall be located only where indicated by ▲ on the sale map, unless approval is obtained from the forester.
- No slash or equipment allowed across blue paint line onto private land at any time, trees shall be felled onto county property and away from private lands.
- Protect survey monuments labeled on timber sale map with a ○. Damage will result in restoration costs paid by the contractor.
- Leave as many snags stand as possible not to compromise safety.
- No whole tree harvesting allowed.
- Woods trails and roads must remain open and free of debris during logging operation.
- No new roads will be permitted.
- Snowmobile/Summer ATV trail shall be kept passable, free of debris, and snow covered during winter months. Signing will be required when using or crossing this trail.

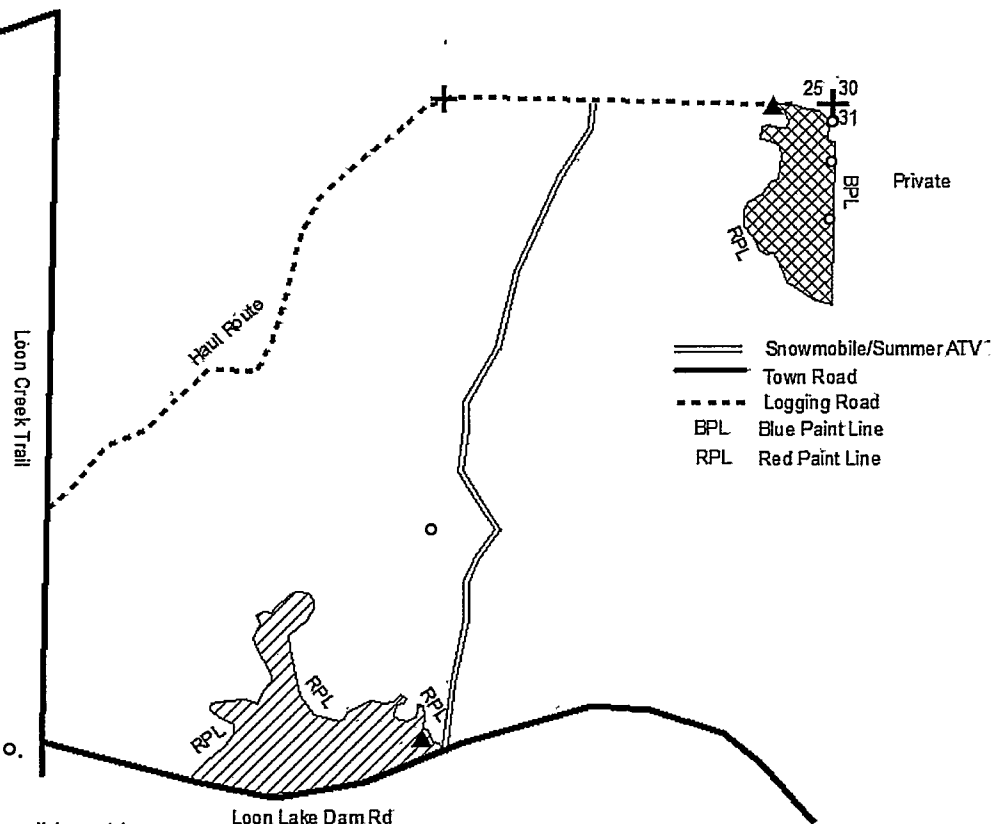

BURNETT COUNTY FOREST TIMBER SALE BID FORM

8150 State Road 70, Siren, WI 54872

Tract # 15-15

I hereby submit the following bid for timber stumpage:

Species	Volume	Bid Price	Total Value by Species
Aspen	4" ton 540 ton		
Jack Pine	3" ton 475 ton		
Red Pine	3" ton 470 ton		
Scrub Oak	4" ton 70 ton		

Total Sale Minimum Bid for Tract #15-15

\$24,765.00

TOTAL SALE VALUE =
=

Bid deposit of \$200.00 per tract is required for bid

Successful bidders will be required to submit a 10% Performance Bond, cash or Irrevocable Letter of Credit, *within ten working days of receiving the contract.*

Do you wish to use the blended species formula for hauling mixed species loads? YES NO

Submitted by: _____
Name

_____ Address

_____ Date

_____ Company Name

_____ City, State, Zip

_____ E-mail address

BURNETT COUNTY FOREST

Mapped By: Mark Diesen			Project Type Timber Sale		Contract #
Date Drawn 11/2/2015			Comp 7	Stand 24,25,27	Contractor
Town E. Blaine			DNR Tract # 24-15		Expiration Date
Twp 42 N	Range 14 W	Section 33,34	Acres 98		Scale 4 inch = 1 mile

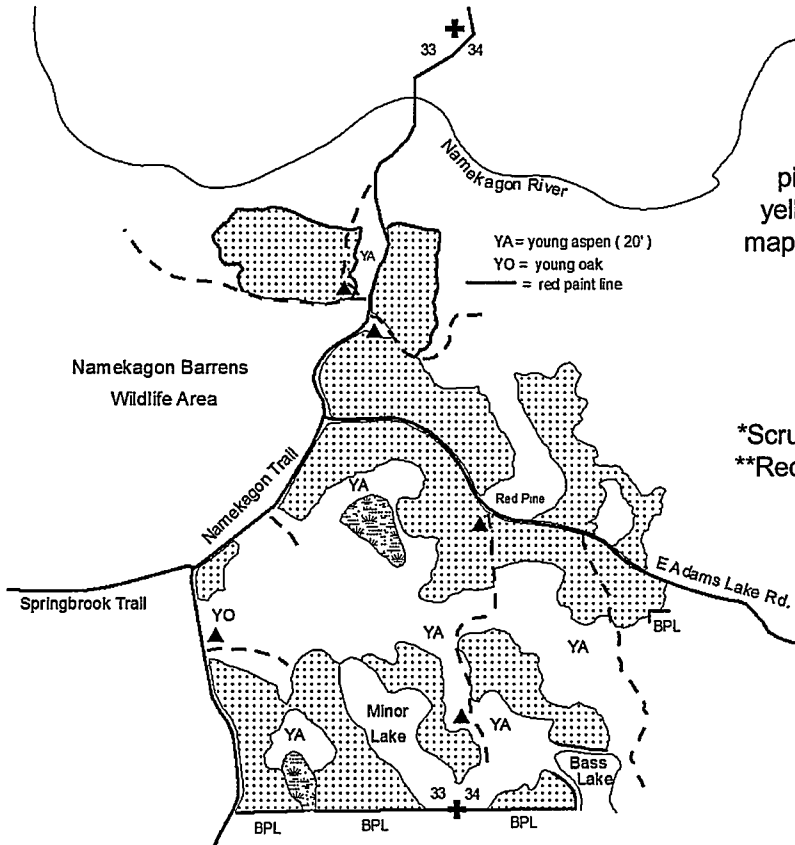

Oak Harvest: Harvest all merchantable oak, aspen, mixed hardwood and pine trees; except leave all trees marked with yellow paint. Any boundaries not labeled on the map are surrounded by young aspen. 98 acres

	Whole tree tons	Shortwood tons
*Scrub oak	4400	3340
**Red pine	180	135

*contains some aspen and birch

**contains some white pine and jack pine

Minimum Value: \$15,226.00

Special Contract Restrictions:

1. Operations are not allowed in the two northern most parts of the sale area (11 and 7 acres north of the woods trails) from March 15th through October 31st to protect endangered species.
2. Due to the occurrence of oak wilt, harvesting is not permitted from April 15th to July 15th.
3. Whole tree harvesting is allowed, **NO** additional topwood will be required to be retained on site.
4. No decking or loading is permitted on town roads, unless approval is obtained from the township.
5. Cutting within the Riparian management zone shall follow WI BMP's for water quality: including no cutting within 100' of the water (minor lake on the map) and no equipment within 15' of wetland edges during non-frozen times of the year.
6. If shortwood harvested, all slash shall be lopped to within 2' of the ground.
7. Landings shall be located only where indicated by ▲ on the sale map, unless approval is obtained from the forester.
8. No slash or equipment allowed across blue paint line onto private land at any time; trees shall be felled onto county property and away from private lands.
9. Woods trails and roads must remain open and free of debris during logging operation.
10. Road approaches to county and town roads are the responsibility of the contractor. Damage to these roads is the responsibility of the contractor. The approach to county or town roads may need improvements prior to hauling to prevent damage.

BURNETT COUNTY FOREST TIMBER SALE BID FORM

8150 State Road 70, Siren, WI 54872

Tract # 24-15

I hereby submit the following bid for timber stumpage:

Species		Volume	Bid Price	Total Value by Species
Scrub Oak	4" ton	3340 ton		
	WT ton	4400 ton		
Red Pine	3" ton	135 ton		
	WT ton	180 ton		

Total Sale Minimum Bid for Tract # 24-15 \$15,226.00

TOTAL SALE VALUE =
=

Bid deposit of \$200.00 per tract is required for bid

Successful bidders will be required to submit a 10% Performance Bond, cash or Irrevocable Letter of Credit, *within ten working days of receiving the contract.*

Do you wish to use the blended species formula for hauling mixed species loads? YES NO

Submitted by: _____
Name

_____ Address

_____ Date

_____ Company Name

_____ City, State, Zip

_____ E-mail address

BURNETT COUNTY FOREST

Mapped By:			Project Type		Contract #
Mark Gossman			Timber Sale		
Date Drawn			Comp	Stand	Contractor
12/7/2015			132	1	
Town			DNR Tract #		Expiration Date
Roosevelt			26-15		
Twp	Range	Section	Acres		Scale
37N	14W	26	108		1" = 1/4 Mile



Red oak Thin. 108 ac. Harvest all trees throughout the sale area marked with orange paint. Leave all other trees undamaged.

	<u>Ton</u>	<u>Approx cords</u>	<u>MBF</u>
Oak Pulp	1510	550	
Mixed Hwd pulp*	1235	475	
Aspen**	100	45	
Mixed Hwd Saw***			9.4
Oak Saw****			33.6

Total Minimum Sale Value \$ 27,350.00

*Mixed hardwood pulp contains 34% Red maple, 27% Basswood, 22% Hard maple, 17% Ash

**Aspen contains a small amount of birch

***Mixed hardwood sawlog contains 55% Basswood, 22% Ash, 16% Hard Maple, 7% Red Maple

****Oak Saw contains 98% Red oak and 2% White oak

Special Contract Restrictions

- Operation will be stopped, if in the opinion of the forester, unnecessary damage occurs.
- Damage to residual trees will result in additional skidding restrictions.
- Ski trails can be used for access, but use must be minimized. Contractor will need to work with the forester to determine what trail can be used. Trails will be leveled and fixed prior to the sale being closed.
- A new road as indicated on the map may be necessary.
- Gate to sale will remain closed during work hours and locked during non-work hours.
- No equipment within 15' of wetland edges.
- All slash shall be lopped to within 2' of the ground.
- Logical landings are indicated by a ▲ on the sale map, additional landings can be constructed with the approval from the contract administrator.
- All Sawtimber and bolts shall be piled with small end facing one direction.
- The county reserves the right to inspect bolt piles prior to hauling to assure no sawtimber is included.
- All sawtimber will be scaled on site by the forester before hauling.
- No slash or equipment allowed across blue paint line onto private land at any time, trees shall be felled onto county property and away from private lands.
- Protect survey monuments shown on timber sale map. Damage will result in restoration costs paid by the contractor.
- Leave as many snags stand as possible not to compromise safety.
- Summer/Fall logging during dry conditions only, no winter cutting or trucking allowed, due to winter recreation activities.**

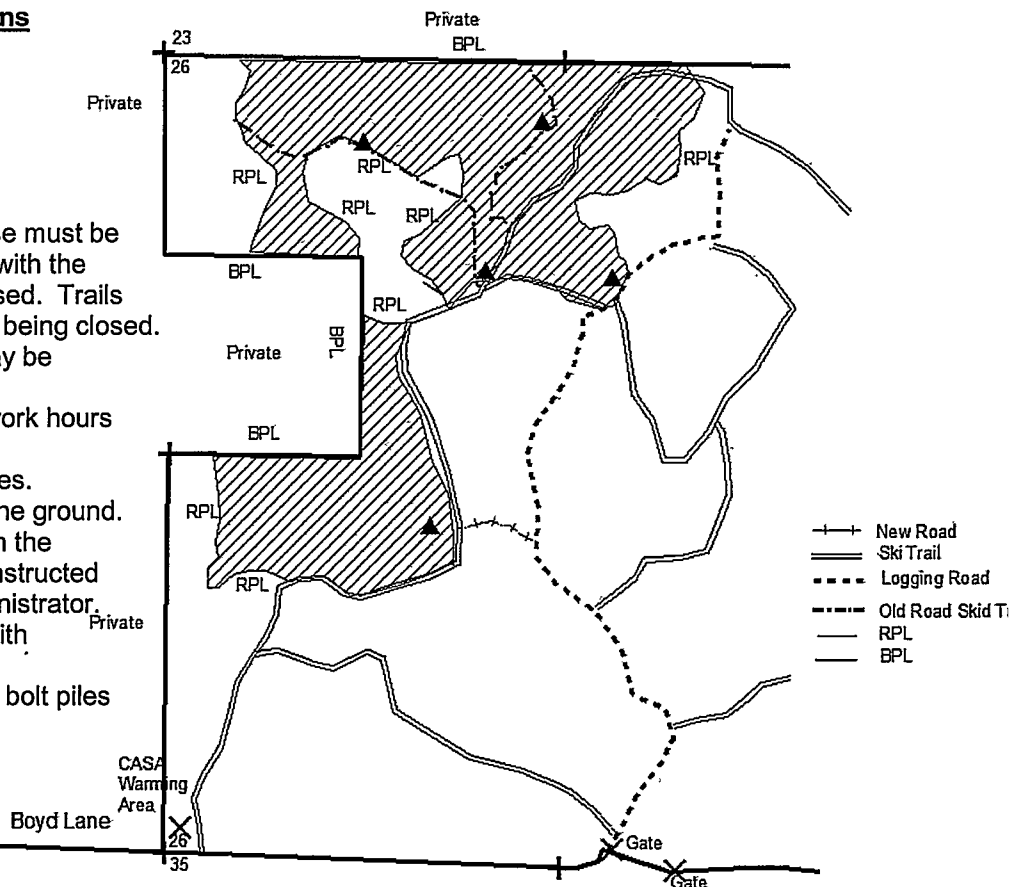

BURNETT COUNTY FOREST TIMBER SALE BID FORM

8150 State Road 70, Siren, WI 54872

Tract # 26-15

I hereby submit the following bid for timber stumpage:

Species		Volume	Bid Price	Total Value by Species
Oak	4" ton <input style="width: 100%; height: 20px;" type="text"/>	1510 ton	<input style="width: 100%; height: 20px;" type="text"/> <input style="width: 100%; height: 20px;" type="text"/>	<input style="width: 100%; height: 20px;" type="text"/> <input style="width: 100%; height: 20px;" type="text"/>
Mixed Hwd	4" ton <input style="width: 100%; height: 20px;" type="text"/>	1235 ton	<input style="width: 100%; height: 20px;" type="text"/> <input style="width: 100%; height: 20px;" type="text"/>	<input style="width: 100%; height: 20px;" type="text"/> <input style="width: 100%; height: 20px;" type="text"/>
Aspen	4" ton <input style="width: 100%; height: 20px;" type="text"/>	100 ton	<input style="width: 100%; height: 20px;" type="text"/> <input style="width: 100%; height: 20px;" type="text"/>	<input style="width: 100%; height: 20px;" type="text"/> <input style="width: 100%; height: 20px;" type="text"/>
Mixed Hwd	MBF <input style="width: 100%; height: 20px;" type="text"/>	9.4 MBF	<input style="width: 100%; height: 20px;" type="text"/> <input style="width: 100%; height: 20px;" type="text"/>	<input style="width: 100%; height: 20px;" type="text"/> <input style="width: 100%; height: 20px;" type="text"/>
Oak	MBF <input style="width: 100%; height: 20px;" type="text"/>	33.6 MBF	<input style="width: 100%; height: 20px;" type="text"/> <input style="width: 100%; height: 20px;" type="text"/>	<input style="width: 100%; height: 20px;" type="text"/> <input style="width: 100%; height: 20px;" type="text"/>

Total Sale Minimum Bid for Tract # 26-15 \$27,350.00

TOTAL SALE VALUE =
=

Bid deposit of \$200.00 per tract is required for bid

Successful bidders will be required to submit a 10% Performance Bond, cash or Irrevocable Letter of Credit, *within ten working days of receiving the contract.*

Do you wish to use the blended species formula for hauling mixed species loads? YES NO

Submitted by: _____
Name

Address

Date Company Name

City, State, Zip

E-mail address

BURNETT COUNTY FOREST

Mapped By:			Project Type	Contract #
Jim Becker			Timber Sale	
Date Drawn:			Comp 84 Stand 22	Contractor
April 28, 2016			Comp 85 Stands 9,19,22,31	
Town			DNR Tract #	Expiration Date
Sand Lake Rusk			12-16	
Twp	Range	Section	Acres	Scale
39	15	12		
39	14	7	43	1" = 1/4 Mile

Black Ash Thin 24 Ac. Cut all orange marked trees and aspen. Frozen ground conditions required.

Red Pine/Hardwood Cut. 6 Ac. Cut orange marked red pine. In addition, cut all merchantable aspen, red maple, birch, and jack pine. Cut oaks smaller than 15" dbh. Portions along Gaslyn Road may be suitable for all season operation

Aspen Area. 13 ac. Cut all merchantable aspen, red maple, white birch. In addition, cut oaks smaller than 15" dbh.

Additional Requirements:

- Cutting in Riparian Management Zone shall follow WI BMP's for water quality.
- Suggested landings indicated by a triangle on map – location to be arranged with forester.
- Existing roads and trails shall be kept passable and free of debris.
- Road to public landing must be kept passable at all times.
- All saw timber will be scaled on site by the forester before hauling.
- There is a "witness monument" about 40' south of the survey corner for section 12 and 7 in Gaslyn Rd. Trees around the witnesses are painted blue – do not cut or damage them.
- Leave as many snags stand as possible not to compromise safety. Slash height 2' or less.
- Proposed access route to the eastern sale block is identified by BPL (blue paint line) on the map and the ground.
- Harvest boundaries include: red paint line (RPL), road, wetlands.
- No equipment operation on private property. No felling trees onto private property.
- If the sale is whole tree harvested one in ten drags of tops must be scattered evenly throughout the sale.

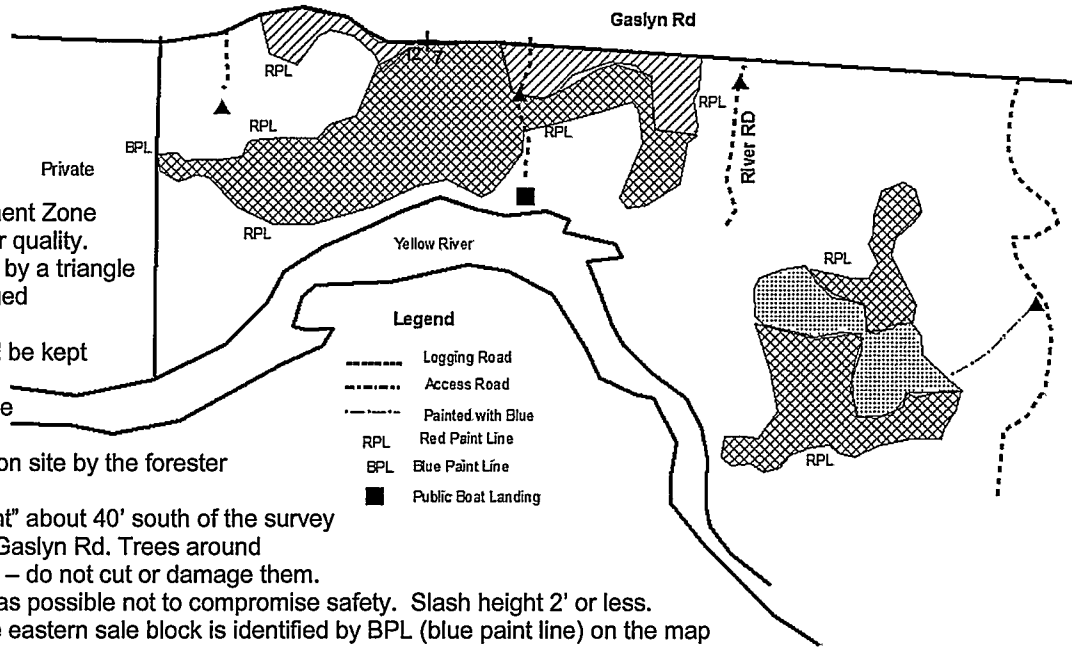

Species	short wood	whole tree
Mixed Hwd*	879 tons	1183 tons
Aspen	446 tons	581 tons
Jack Pine**	46 tons	62 tons
Oak	115 tons	150 tons
Mixed Hwd (87% ash)	21.3 mbf	
Red Pine	9 mbf	

*Mixed Hwd contains 72% maple, 16% ash, 11% birch

**Includes red pine tops

Sale Minimum Bid = \$19,953.50

BURNETT COUNTY FOREST TIMBER SALE BID FORM

8150 State Road 70, Siren, WI 54872

Tract #12-16

I hereby submit the following bid for timber stumpage:

Species		Volume	Bid Price	Total Value by Species
Mix Hardwood	4" ton	879 ton		
	WT ton	1183 ton		
Aspen	4" ton	446 ton		
	WT ton	581 ton		
Jack Pine	3" ton	46 ton		
	WT ton	62 ton		
Oak	4" ton	115 ton		
	WT ton	150 ton		
Mix Hardwood	MBF	21.3 MBF		
Red Pine	MBF	9 MBF		

Total Sale Minimum Bid for Tract #12-16 \$19,953.50

TOTAL SALE VALUE =
=

Bid deposit of \$200.00 per tract is required for bid

Successful bidders will be required to submit a 10% Performance Bond, cash or Irrevocable Letter of Credit, *within ten working days of receiving the contract.*

Do you wish to use the blended species formula for hauling mixed species loads? YES NO

Submitted by: _____
Name

_____ Address

_____ Date

_____ Company Name

_____ City, State, Zip

_____ E-mail address

BURNETT COUNTY FOREST

Mapped By: Bryson Grubbs			Project Type Timber Sale		Contract #
Date Drawn 11/21/2016			Comp 135	Stand 6	Contractor
Town Oakland			DNR Tract # 26-16		Expiration Date
Twp 40N	Range 16W	Section 6	Acres 50		Scale 1 inch = ¼ mile



Scrub Oak/Aspen Removal: Cut all pin oak, aspen, and jack pine. Leave all white oak and all red and white pine standing. Avoid heavy traffic with machines where there are pockets of dense aspen saplings. **50 acres**

Special Contract Restrictions

1. Biomass harvesting will not be allowed due to poor quality soils.
2. Landings shall be located only where indicated by ▲ on the sale map, unless approval is obtained from the forester.
3. No new access points allowed.
4. Site maintenance is not required.
5. No whole tree skidding allowed due to the existing aspen regen on this sale, shortwood and pole skidding is allowed.
6. Avoid machine traffic in pockets with dense aspen saplings.
7. Protect survey monuments shown on the sale map.
8. Due to the occurrence of oak wilt, harvesting is not permitted from April 15th to July 15th
9. All jack pine is to be utilized down to a 3 inch top diameter.
10. Extra caution shall be made to avoid damaging residual trees and regen.
11. No slash or equipment allowed across blue paint line onto private land at any time, trees shall be felled on to county property and away from private lands.

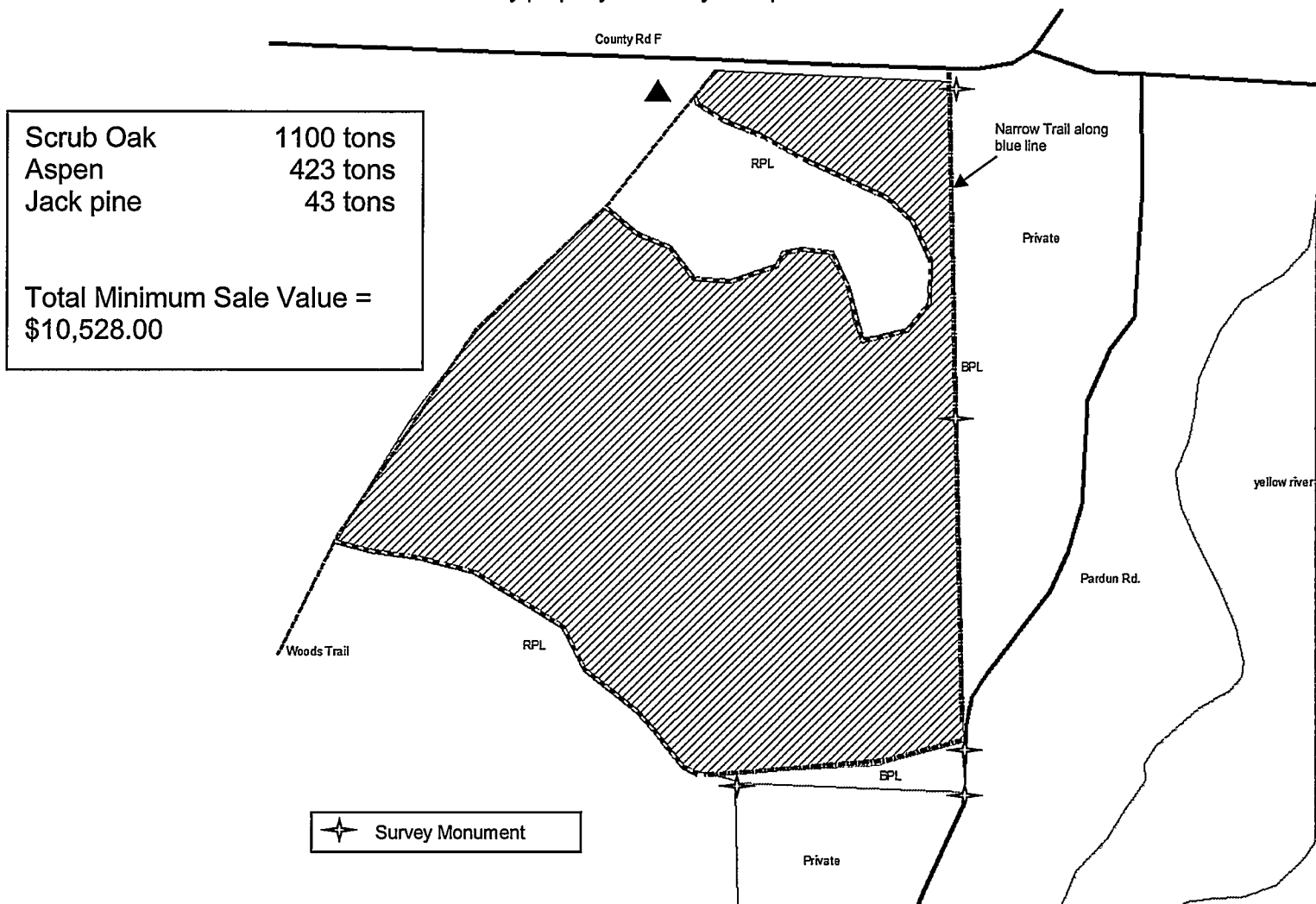

Scrub Oak	1100 tons
Aspen	423 tons
Jack pine	43 tons
Total Minimum Sale Value =	
\$10,528.00	

BURNETT COUNTY FOREST TIMBER SALE BID FORM

8150 State Road 70, Siren, WI 54872

Tract # 26-16

I hereby submit the following bid for timber stumpage:

Species	Volume	Bid Price	Total Value by Species
Scrub Oak	1100 ton		
Aspen	423 ton		
Jack Pine	43 ton		

Total Sale Minimum Bid for Tract #26-16 \$10,528.00

TOTAL SALE VALUE =
=

Bid deposit of \$200.00 per tract is required for bid

Successful bidders will be required to submit a 10% Performance Bond, cash or Irrevocable Letter of Credit, *within ten working days of receiving the contract.*

Do you wish to use the blended species formula for hauling mixed species loads? YES NO

Submitted by: _____
Name

Address

Date

Company Name

City, State, Zip

E-mail address

BURNETT COUNTY FOREST

Mapped By: Eric Peterson			Project Type Timber Sale		Contract #
Date Drawn 12/08/2016			Comp 27	Stand 3, 20	Contractor
Town Blaine			DNR Tract # 30-16		Expiration Date
Twp 42N	Range 14W	Section 15	Acres 16		Scale 1inch=1/4 mile

- RPL (Red Paint Line)
- ⊕ Section Corners
- ▲ Landings
- ATV/Snowmobile Trail
- Unpaved Road
- Paved Road
- Wetlands

Tract # 30-16 Seed Tree/Coppice with Standards

Harvest all Hardwoods 2 inches DBH and larger. Leave all white oaks, aspen, and pine.

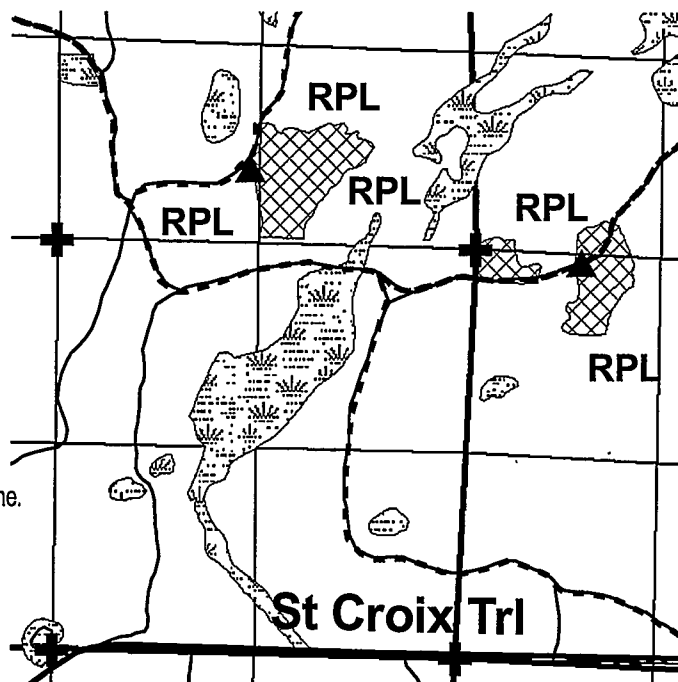

Species	Tons	Cords
Scrub oak	435	171
Minimum Bid = \$1,740.00		

Special Contract Restriction Burnett County Forest Timber Sales

01. All wood cut or in piles shall be removed within 30 days.
02. Operation will be stopped, if in the opinion of the forester unnecessary damage occurs.
03. Damage to residual trees will result in additional skidding restrictions.
04. Snowmobile/ATV trail shall be kept passable, free of debris and snow covered during winter.
05. All slash shall be lopped to within 2' of the ground.
06. Landings shall be located only where indicated by ▲ on the sale map, unless approval is obtained from the forester.
07. No cutting of white oak, aspen, or pine species with sale area.
08. Protect survey monuments shown on timber sale map. Damage will result in restoration costs paid by the contractor.
09. Survey monuments have been identified by ⊕ on the map.
10. Leave as many snags stand as possible not to compromise safety.
11. Due to poor quality soils, no whole tree harvesting allowed to comply with WI Bio-Mass Harvesting Guidelines.
12. Due to the occurrence of oak wilt, harvesting is not permitted from April 15th to July 15th.
13. No new access points will be allowed.
14. Access points from St. Croix Trail are shown on the map. No additional access points will be permitted.
15. Woods trails and roads must remain open and free of debris during logging operation.
16. No new roads will be permitted.

BURNETT COUNTY FOREST TIMBER SALE BID FORM

8150 State Road 70, Siren, WI 54872

Tract # 30-16

I hereby submit the following bid for timber stumpage:

Species		Volume	Bid Price	Total Value by Species
Scrub Oak	4" ton	435 ton		

Total Sale Minimum Bid for Tract #30-16

\$1,740.00

TOTAL SALE VALUE =
=

Bid deposit of \$200.00 per tract is required for bid

Successful bidders will be required to submit a 10% Performance Bond, cash or Irrevocable Letter of Credit, *within ten working days of receiving the contract.*

Do you wish to use the blended species formula for hauling mixed species loads? YES NO

Submitted by: _____
Name

_____ Address

_____ Date

_____ Company Name

_____ City, State, Zip

_____ E-mail address